

Dimensions

MODEL	A	B	C
SHm 180F	184	140	373
SHm 250F	184	140	393
SHm 450F	251	200	463
SHm 750F	251	200	461
SHm 1100F	251	200	523
SHm 1500F	251	200	535

Application

- ◆ Wastewater drainage in factories, construction sites and commercial facilities
- ◆ Drainage system in municipal sewage treatment plants
- ◆ Drainage station in residential quarters
- ◆ Municipal projects
- ◆ Methane pools and field irrigation in countryside

Pump

- ◆ Max: immersion depth: 5m
- ◆ Max: liquid temperature: +40°C
- ◆ Liquid PH value: 5-9
- ◆ Liquid kinematic viscosity: $7 \times 10^{-6} \sim 23 \times 10^{-6} \text{m}^2/\text{s}$
- ◆ Max. liquid density: $1.2 \times 10^3 \text{kg}/\text{m}^3$

Motor

- ◆ Copper winding
- ◆ Built-in thermal protector
- ◆ Stainless steel welded shaft
- ◆ Insulation class :B
- ◆ Protection class:IPX8

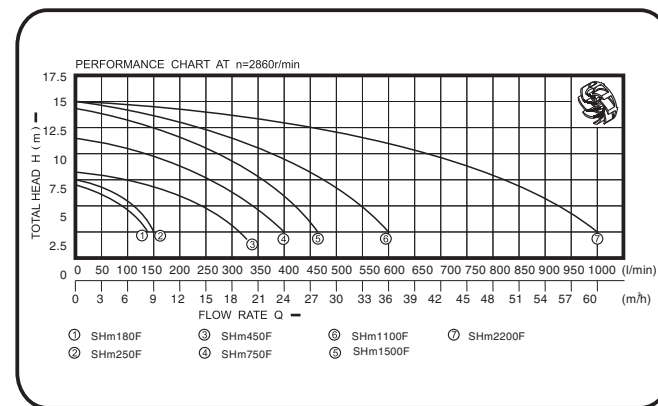

Technical Table

Model	Power (kw)	Outlet Diameter (mm)	Voltage/Frequency (V/Hz)	Max. Flow (l/min)	Max. Head (m)	Max. Diameter of Particle (mm)	G.W. (kg)	Dimensions (cm)
SHm 180F	0.18	32	220/50	133	7	25	9.6	22.5X18.5X42.0
SHm 250F	0.25	32	220/50	150	7.5	25	10.6	22.5X18.5X44.0
SHm 450F	0.45	50	220/50	333	8.5	40	20	30.0X24.5X53.0
SHm 750F	0.75	50	220/50	400	11.5	40	22.6	30.0X24.5X56.0
SHm 1100F	1.1	50	220/50	466	14.5	40	23.6	30.0X24.5X57.0
SHm 1500F	1.5	50	220/50	600	15	40	32.8	34.5X30.0X66.0
SHm 2200F	2.2	100	220/50	1000	15	20	38	39.0X28.0X60.0

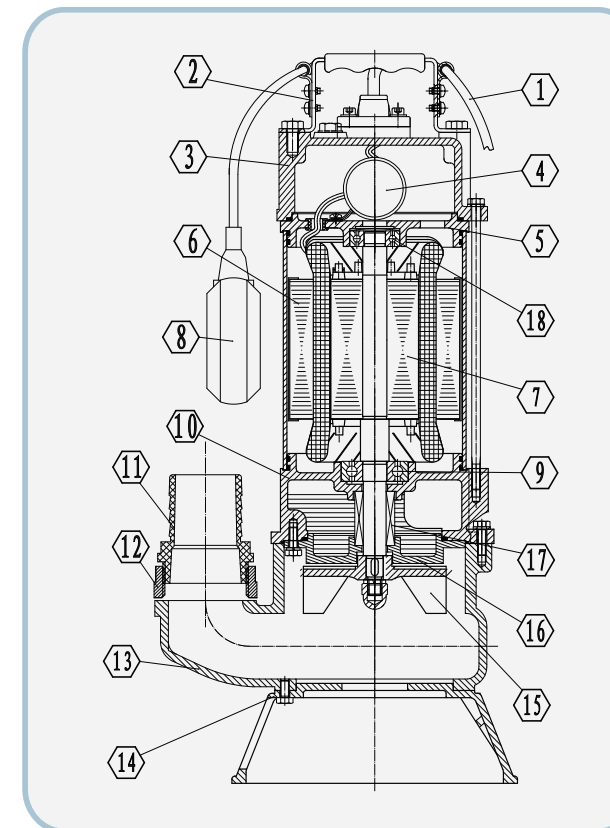

NO.	NAME	MATERIAL/SPEC.
1	Cable components	
2	Handle	AISI201
3	Capacitor Cover	HT200
4	Capacitor	
5	Upper cover	HT200
6	Motor	AISI201(Motor casing)
7	Rotor	AISI304
8	Float Switch (optional)	
9	Bearing(DGBB)	
10	Connecting Base	HT200
11	Out-let connector	ABS
12	Flange connector	HT200
13	Pump Body	HT200
14	Base plate	HT200
15	Impeller	HT200
16	Cylinder Cover	HT200
17	Double Mechanical Seal	Ceramic/Graphite
18	Bearing(DGBB)	